

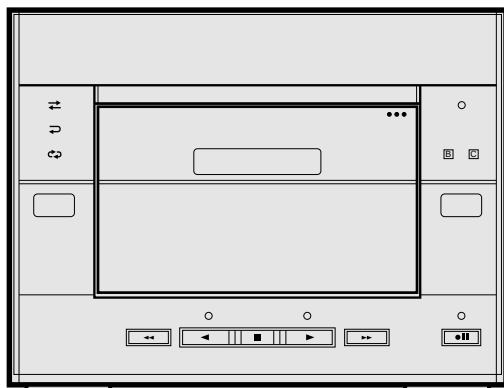

SHARP SERVICE MANUAL

No. S4727RTXV300H



RT-XV300H

DOLBY B-C NR

- Dolby noise reduction manufactured under license from Dolby Laboratories Licensing Corporation.
- "DOLBY" and the double-D symbol  are trademarks of Dolby Laboratories Licensing Corporation.

• In the interests of user-safety the set should be restored to its original condition and only parts identical to those specified should be used.

CONTENTS

	Page
IMPORTANT SERVICE NOTES (FOR UK ONLY)	2
WIRING OF PRIMARILY SUPPLY LEADS (FOR UK ONLY)	2
SPECIFICATIONS	3
NAMES OF PARTS	3
DISASSEMBLY	4
ADJUSTMENT	5
BLOCK DIAGRAM	6
SCHEMATIC DIAGRAM / WIRING SIDE OF P.W.BOARD	8
FUNCTION TABLE OF IC	12
NOTES ON SCHEMATIC DIAGRAM	14
TYPES OF TRANSISTOR AND LED	14
REPLACEMENT PARTS LIST / EXPLODED VIEW	
PACKING OF THE SET (FOR UK ONLY)	

ADJUSTMENT

MECHANISM SECTION

• Driving Force Check

Torque Meter	Specified Value
Play: TW-2412	80 g or more
Reverse Play: TW-2422	80 g or more

• Checking the playback/FF/rewinding torque

Torque Meter	Specified Value
Play: TW-2111	25 to 65 g. cm
Reverse Play: TW-2121	25 to 65 g.cm
Fast forward: TW-2231	60 to 130 g.cm
Rewind: TW-2231	60 to 130 g.cm

• Adjusting the record/playback head azimuth

Test Tape	Connection
MTT - 114	Output: L: TP102① R: TP102④

* Raise the cassette holder cover and remove it, and then adjust the azimuth.

Adjusting the deck circuit

• Checking the bias oscillation frequency

Adjusting object	Set value	Connection
—	85 ±7kHz	TP101 ① or ③

• Checking the bias current

Adjusting object	Set value	Connection
L: VR105 R: VR106	Standard: 15 ± 3 mV	L: TP101 ① R: TP101 ③

• Adjusting the playback amplifier sensitivity

Test Tape	Connection	Set value	Connection
MTT-150	L: VR101 R: VR102	Standard: 580mV	L: TP102 ① R: TP102 ④

• Adjusting the record/playback amplifier sensitivity

Test Tape	Connection	Set value	Connection
UR-121	Record level control	200mV	Input:AUX (1kHz) Output: L: TP102 ① R: TP102 ④
	L: VR103 R: VR104	200mV	

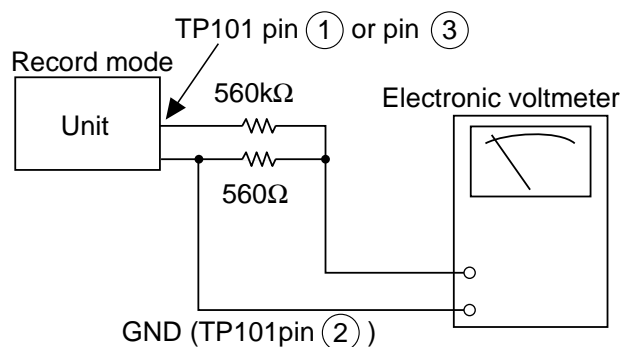

Figure 5-1 BIAS CURRENT

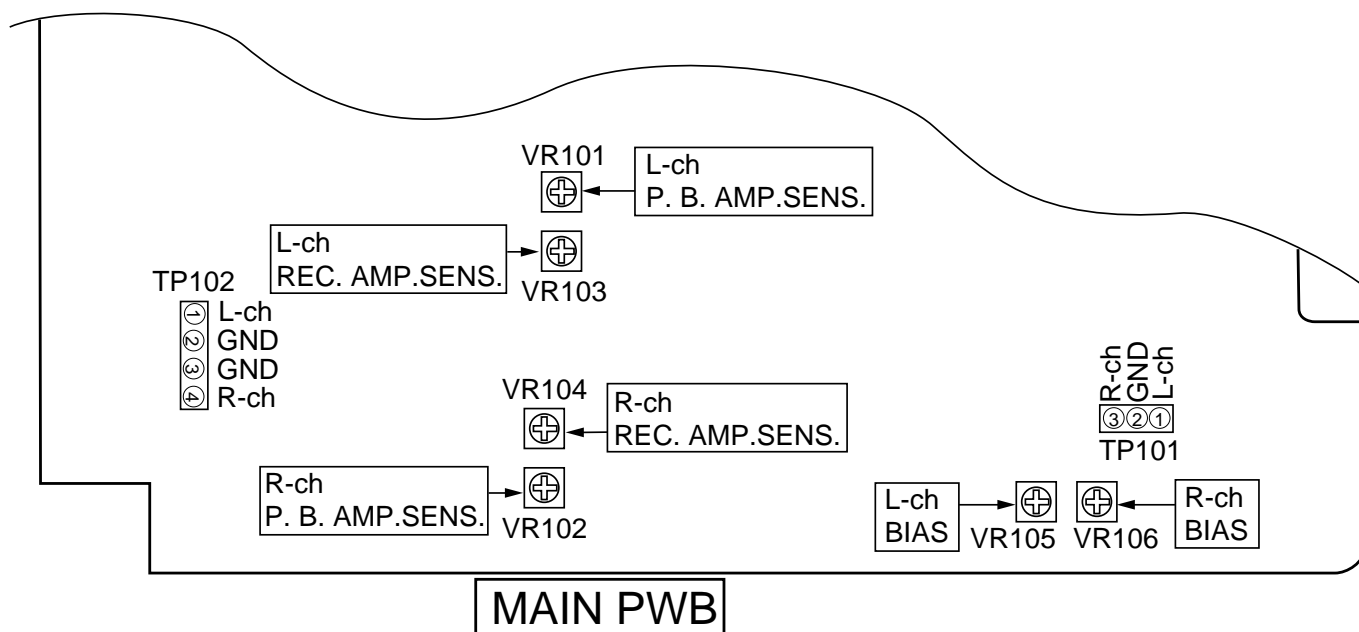

Figure 5-2 ADJUSTMENT POINTS

EQUALIZER AMP.
IC101
M51167BFP

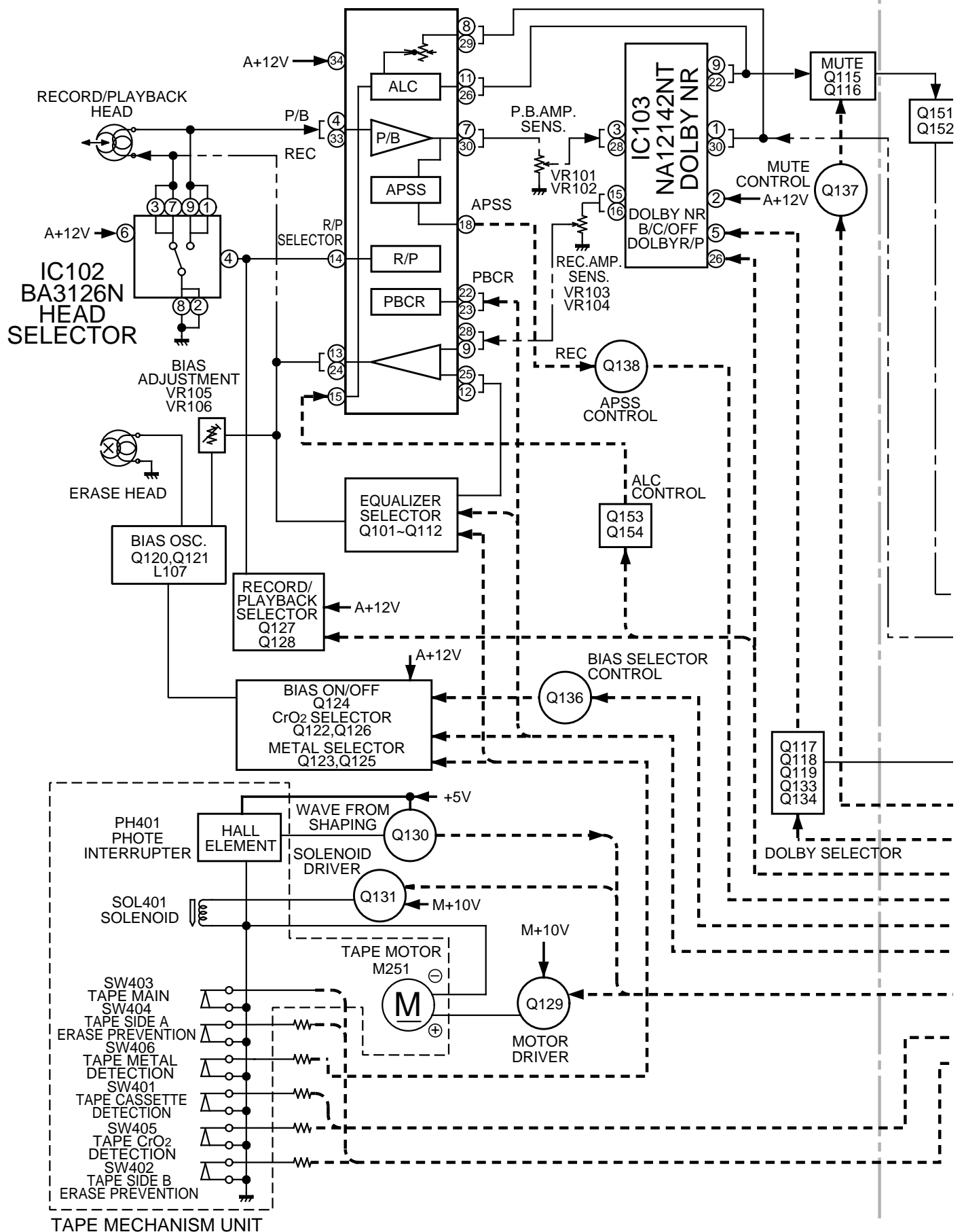

Figure 6 BLOCK DIAGRAM (1/2)

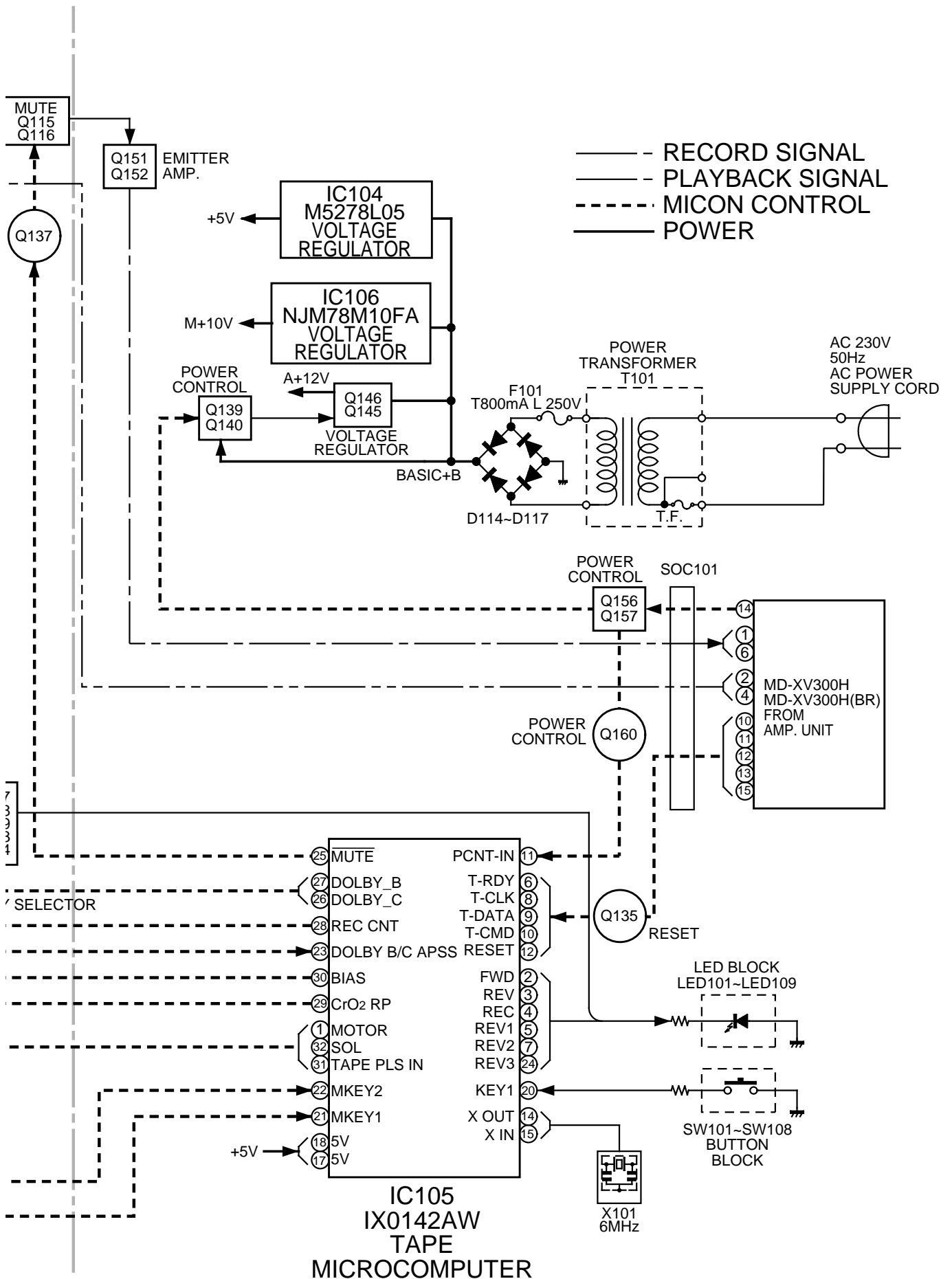
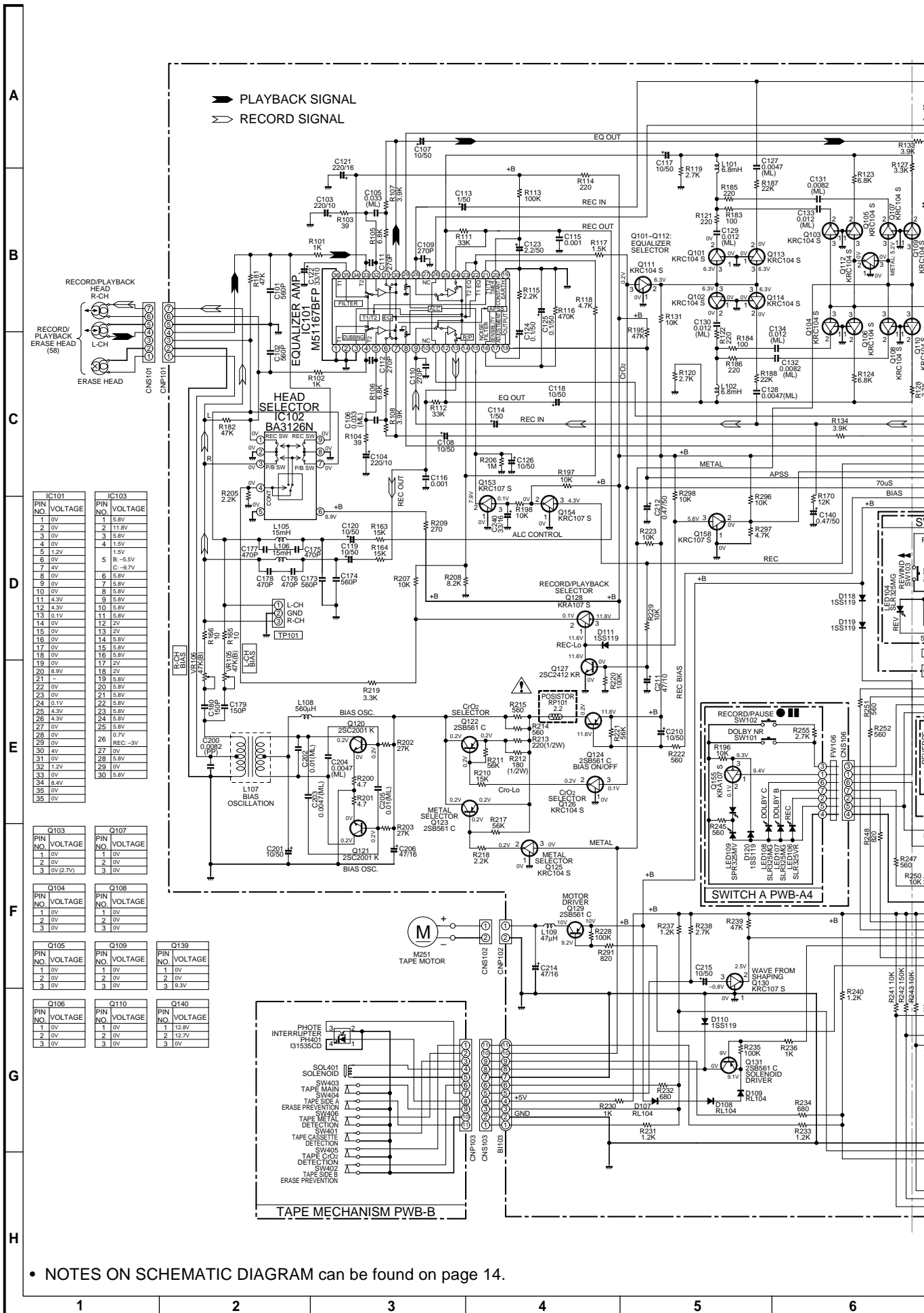

Figure 7 BLOCK DIAGRAM (2/2)



• NOTES ON SCHEMATIC DIAGRAM can be found on page 14.

Figure 8 SCHEMATIC DIAGRAM (1/2)

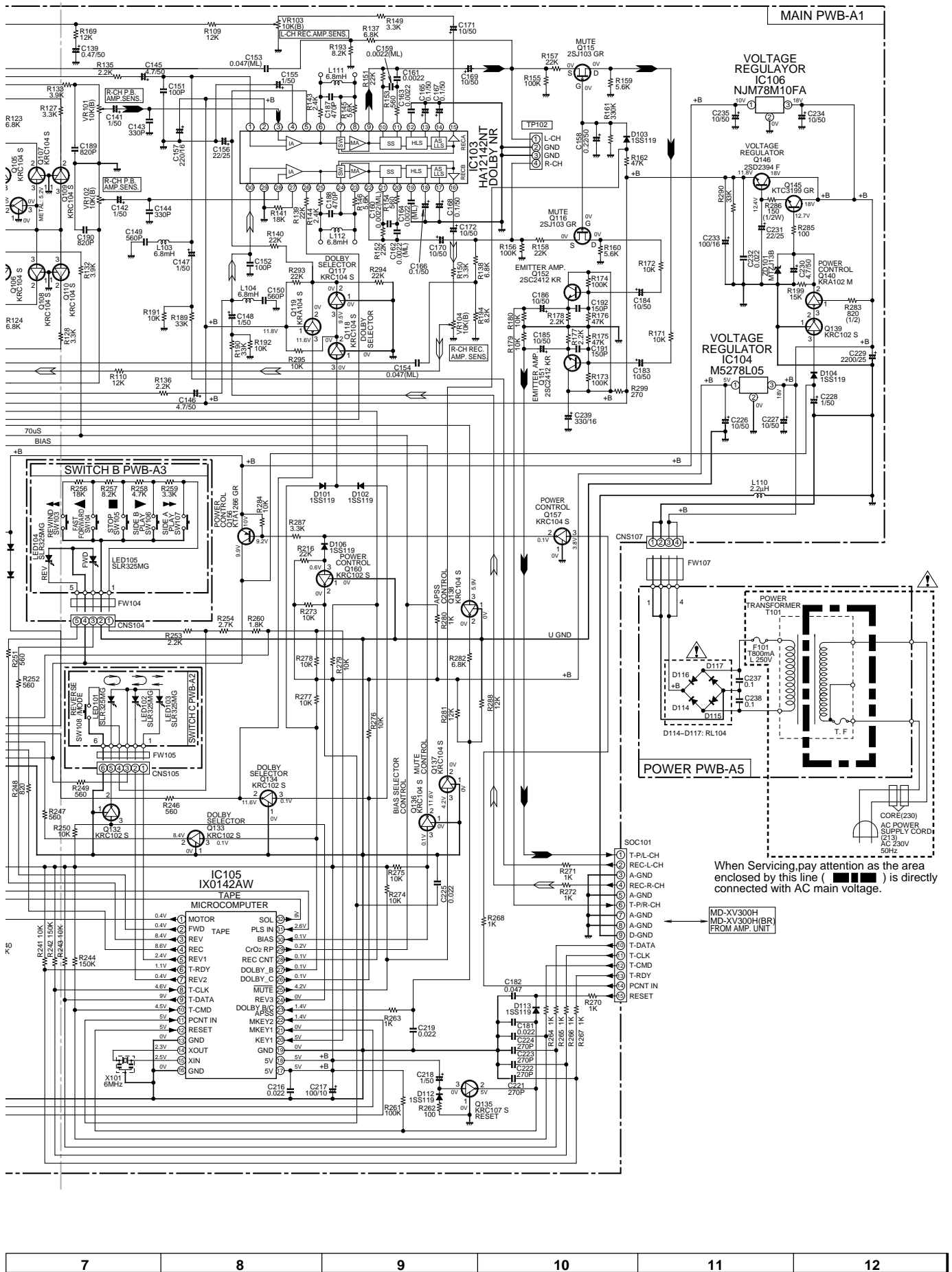

Figure 9 SCHEMATIC DIAGRAM (2/2)

RT-XV300H

NO.	PART CODE	★ PRICE RANK	DESCRIPTION
IC101	VHIM51167BFP1	J AL	Equalizer Amp.,M51167BFP1
IC102	VHIBA3126N/-1	J AF	Head Selector,BA3126N
IC103	VHIHA12142NT1	J AS	Dolby NR,HA12142NT
IC104	VHIM5278L05-1	J AE	Voltage Regulator,M5278L05
IC105	RH-IX0142AWZZ	J AP	Tape Microcomputer,IX0142AW
IC106	VHINJM78M10FA	J AE	Voltage Regulator,NJM78M10FA

TRANSISTORS

Q101~114	VSKRC104S// -1	J AC	Digital,NPN,KRC104 S
Q115,116	VS2SJ103GR/-1	J AC	FET,2SJ103 GR
Q117,118	VSKRC104S// -1	J AC	Digital,NPN,KRC104 S
Q119	VSKRA104S// -1	J AC	Digital,NPN,KRA104 S
Q120,121	VS2SC2001-K-1	J AD	Silicon,NPN,2SC2001 K
Q122~124	VS2SB561-C/-1	J AC	Silicon,PNP,2SB561 C
Q125,126	VSKRC104S// -1	J AC	Digital,NPN,KRC104 S
Q127	VS2SC2412KR-1	J AB	Silicon,NPN,2SC2412 KR
Q128	VSKRA107S// -1	J AB	Digital,NPN,KRA107 S
Q129	VS2SB561-C/-1	J AC	Silicon,PNP,2SB561 C
Q130	VSKRC107S// -1	J AB	Digital,NPN,KRC107 S
Q131	VS2SB561-C/-1	J AC	Silicon,PNP,2SB561 C
Q132~134	VSKRC102S// -1	J AB	Digital,NPN,KRC102 S
Q135	VSKRC107S// -1	J AB	Digital,NPN,KRC107 S
Q136~138	VSKRC104S// -1	J AC	Digital,NPN,KRC104 S
Q139	VSKRC102S// -1	J AB	Digital,NPN,KRC102 S
Q140	VSKRA102M// -1	J AC	Digital,PNP,KRA102 M
Q145	VSKTC3199GR-1	J AB	Digital,NPN,KTC3199 GR
Q146	VS2SD2394F/-1	J AE	Silicon,NPN,2SD2394 F
Q151,152	VS2SC2412KR-1	J AB	Silicon,NPN,2SC2412 KR
Q153,154	VSKRC107S// -1	J AB	Digital,NPN,KRC107 S
Q155	VSKRA107S// -1	J AB	Digital,NPN,KRA107 S
Q156	VSKTA1266GR-1	J AB	Digital,PNP,KTA1266 GR
Q157	VSKRC104S// -1	J AC	Digital,NPN,KRC104 S
Q158	VSKRC107S// -1	J AB	Digital,NPN,KRC107 S
Q160	VSKRC102S// -1	J AB	Digital,NPN,KRC102 S

DIODES

D101~104	VHD1SS119// -1	J AA	Silicon,1SS119
D106	VHD1SS119// -1	J AA	Silicon,1SS119
D107~109	VHDRL104// -1	J AB	Silicon,RL104
D110~113	VHD1SS119// -1	J AA	Silicon,1SS119
△ D114~117	VHDRL104// -1	J AB	Silicon,RL104
D118~120	VHD1SS119// -1	J AA	Silicon,1SS119
LED101~105	VHPSLR325MG-1	J AE	LED,Green,SLR325MG
LED106	VHPSLR325VR-1	J AE	LED,Red,SLR325VR
LED107,108	VHPSLR325MG-1	J AE	LED,Green,SLR325MG
LED109	VHPSPR325MV-1	J AF	LED,Red,SPR325MV
ZD101	VHEMTZJ130B-1	J AC	Zener,13V,MTZJ13B

TRANSFORMER

△ T101	RTRNP0139AWZZ	J AZ	Power
--------	---------------	------	-------

COILS

L101~104	RCILC0094AFZZ	J AD	6.8 mH
L105,106	RCILZ0013AWZZ	J AD	15 mH
L107	RCILB0059AWZZ	J AE	Bias Oscillation
L108	VP-CH561K0000	J AB	560 μH,Choke
L109	VP-YF470K0000	J AB	47 μH,Choke
L110	VP-CH2R2K0000	J AB	2.2 μH,Choke
L111,112	RCILC0094AFZZ	J AD	6.8 mH

VARIABLE RESISTORS

VR101	RVR-M0999AFZZ	J AB	10 kohm (B),Semi-VR [L-ch P.B.Amp.,Sens.]
VR102	RVR-M0999AFZZ	J AB	10 kohm (B),Semi-VR [R-ch P.B.Amp.,Sens.]
VR103	RVR-M0999AFZZ	J AB	10 kohm (B),Semi-VR [L-ch Rec.Amp.,Sens.]
VR104	RVR-M0999AFZZ	J AB	10 kohm (B),Semi-VR [R-ch Rec.Amp.,Sens.]
VR105	RVR-M1003AFZZ	J AB	47 kohms (B),Semi-VR [L-ch Bias]
VR106	RVR-M1003AFZZ	J AB	47 kohms (B),Semi-VR [R-ch Bias]

VIBRATOR

X101	RCRM-0119AFZZ	J AD	Ceramic,6 MHz
------	---------------	------	---------------

CAPACITORS

C101,102	VCCSPA1HL561J	J AA	560 pF,50V
C103,104	RC-GZA227AF1A	J AB	220 μF,10V,Electrolytic
C105,106	RC-QZA333AFYJ	J AB	0.033 μF,50V,Mylar
C107,108	RC-GZA106AF1H	J AB	10 μF,50V,Electrolytic
C109~112	VCCSTV1HL271J	J AA	270 pF,50V
C113,114	RC-GZA105AF1H	J AB	1 μF,50V,Electrolytic
C115,116	VCKYTV1HB102K	J AA	0.001 μF,50V
C117~120	RC-GZA106AF1H	J AB	10 μF,50V,Electrolytic
C121	RC-GZA227AF1C	J AB	220 μF,16V,Electrolytic
C122	RC-GZA336AF1A	J AB	33 μF,10V,Electrolytic
C123	RC-GZA225AF1H	J AB	2.2 μF,50V,Electrolytic
C124,125	RC-GZA104AF1H	J AB	0.012 μF,50V,Mylar
C126	RC-GZA106AF1H	J AB	10 μF,50V,Electrolytic
C127,128	RC-QZA472AFYJ	J AA	0.0047 μF,50V,Mylar
C129,130	RC-QZA123AFYJ	J AB	0.012 μF,50V,Mylar
C131,132	RC-QZA822AFYJ	J AB	0.0082 μF,50V,Mylar
C133,134	RC-QZA123AFYJ	J AB	0.012 μF,50V,Mylar
C139,140	RC-GZA474AF1H	J AA	0.47 μF,50V,Electrolytic
C141,142	RC-GZA105AF1H	J AB	1 μF,50V,Electrolytic
C143,144	VCCSTV1HL331J	J AA	330 pF,50V
C145,146	RC-GZA475AF1H	J AB	4.7 μF,50V,Electrolytic
C147,148	RC-GZA105AF1H	J AB	1 μF,50V,Electrolytic
C149,150	VCCSTV1HL561J	J AB	560 pF,50V
C151,152	VCCSTV1HL101J	J AA	100 pF,50V
C153,154	RC-QZA473AFYJ	J AB	0.047 μF,50V,Mylar
C155	RC-GZA105AF1H	J AB	1 μF,50V,Electrolytic
C156	RC-GZA226AF1E	J AB	22 μF,25V,Electrolytic
C157	RC-GZA227AF1C	J AB	220 μF,16V,Electrolytic
C158	RC-GZA224AF1H	J AA	0.22 μF,50V,Electrolytic
C159~164	RC-QZA222AFYJ	J AB	0.0022 μF,50V,Mylar
C165~168	RC-GZA104AF1H	J AB	0.1 μF,50V,Electrolytic
C169~172	RC-GZA106AF1H	J AB	10 μF,50V,Electrolytic
C173,174	VCCSPA1HL561J	J AA	560 pF,50V
C175~178	VCCSPA1HL471J	J AA	470 pF,50V
C179,180	VCCSPA1HL151J	J AA	150 pF,50V
C181	VCKYTV1EF223Z	J AA	0.022 μF,25V
C182	VCKYTV1EF473Z	J AB	0.047 μF,25V
C183~186	RC-GZA106AF1H	J AB	10 μF,50V,Electrolytic
C187,188	VCCSTV1HL471J	J AA	470 pF,50V
C189,190	VCCSTV1HL821J	J AB	820 pF,50V
C191,192	VCCSTV1HL151J	J AA	150 pF,50V
C200	VCQPKA2AA822J	J AA	0.0082 μF,100V,Polypropylene
C201	RC-GZA106AF1H	J AB	10 μF,50V,Electrolytic
C202	RC-QZA103AFYJ	J AC	0.01 μF,50V,Mylar
C203,204	RC-QZA472AFYJ	J AA	0.0047 μF,50V,Mylar
C205	RC-QZA103AFYJ	J AC	0.01 μF,50V,Mylar
C206	RC-GZA476AF1C	J AB	47 μF,16V,Electrolytic
C210	RC-GZA106AF1H	J AB	10 μF,50V,Electrolytic
C211	RC-GZA476AF1A	J AB	47 μF,10V,Electrolytic
C212	RC-GZA474AF1H	J AA	0.47 μF,50V,Electrolytic
C214	RC-GZA476AF1C	J AB	47 μF,16V,Electrolytic
C215	RC-GZA106AF1H	J AB	10 μF,50V,Electrolytic
C216	VCKYTV1EF223Z	J AA	0.022 μF,25V
C217	RC-GZA107AF1A	J AB	100 μF,10V,Electrolytic
C218	RC-GZA105AF1H	J AB	1 μF,50V,Electrolytic
C219	VCKYTV1EF223Z	J AA	0.022 μF,25V
C221~224	VCCSTV1HL271J	J AA	270 pF,50V
C225	VCKYTV1EF223Z	J AA	0.022 μF,25V
C226,227	RC-GZA106AF1H	J AB	10 μF,50V,Electrolytic
C228	RC-GZA105AF1H	J AB	1 μF,50V,Electrolytic
C229	RC-GZV228AF1E	J AE	2200 μF,25V,Electrolytic
C230	RC-GZA475AF1H	J AB	4.7 μF,50V,Electrolytic
C231	RC-GZA226AF1E	J AB	22 μF,25V,Electrolytic
C232	VCKYTV1EF223Z	J AA	0.022 μF,25V
C233	RC-GZA107AF1C	J AB	100 μF,16V,Electrolytic
C234,235	RC-GZA106AF1H	J AB	10 μF,50V,Electrolytic
C237,238	VCFYHA1HA104J	J AB	0.1 μF,50V,Thin Film
C239	RC-GZA337AF1C	J AC	330 μF,16V,Electrolytic
C240	RC-GZA336AF1C	J AB	33 μF,16V,Electrolytic

RESISTORS

R101,102	VRS-TV2AB000J	J AA	0 ohm,Jumper,1.25x2mm,Green
R103,104	VRS-TV2AB102J	J AA	1 kohm,1/10W
	VRS-TV2AB390J	J AA	39 ohms,1/10W
R105,106	VRS-TV2AB682J	J AA	6.8 kohms,1/10W

NO.	PART CODE	★ PRICE RANK	DESCRIPTION	NO.	PARTS CODE	★ PRICE RANK	DESCRIPTION
R107,108	VRS-TV2AB392J	J AA	3.9 kohms,1/10W	R241	VRD-ST2EE103J	J AA	10 kohm,1/4W
R109,110	VRS-TV2AB123J	J AA	12 kohms,1/10W	R242	VRD-ST2EE154J	J AA	150 kohms,1/4W
R111,112	VRS-TV2AB333J	J AA	33 kohms,1/10W	R243	VRD-ST2EE103J	J AA	10 kohm,1/4W
R113	VRS-TV2AB104J	J AA	100 kohm,1/10W	R244	VRD-ST2EE154J	J AA	150 kohms,1/4W
R114	VRD-ST2EE221J	J AA	220 ohms,1/4W	R245	VRD-ST2CD561J	J AA	560 ohms,1/6W
R115	VRS-TV2AB222J	J AA	2.2 kohms,1/10W	R246,247	VRD-ST2EE561J	J AA	560 ohms,1/4W
R116	VRS-TV2AB474J	J AA	470 kohms,1/10W	R248	VRD-ST2EE821J	J AA	820 ohms,1/4W
R117	VRD-ST2EE152J	J AA	1.5 kohms,1/4W	R249	VRD-ST2EE561J	J AA	560 ohms,1/4W
R118	VRD-ST2CD472J	J AA	4.7 kohms,1/6W	R250	VRS-TV2AB103J	J AA	10 kohm,1/10W
R119,120	VRS-TV2AB272J	J AA	2.7 kohms,1/10W	R251,252	VRD-ST2EE561J	J AA	560 ohms,1/4W
R121,122	VRS-TV2AB221J	J AA	220 ohms,1/10W	R253	VRS-TV2AB222J	J AA	2.2 kohms,1/10W
R123,124	VRS-TV2AB682J	J AA	6.8 kohms,1/10W	R254,255	VRS-TV2AB272J	J AA	2.7 kohms,1/10W
R127,128	VRS-TV2AB332J	J AA	3.3 kohms,1/10W	R256	VRS-TV2AB183J	J AA	18 kohms,1/10W
R131	VRD-ST2CD103J	J AA	10 kohm,1/6W	R257	VRS-TV2AB822J	J AA	8.2 kohms,1/10W
R132	VRD-ST2CD392J	J AA	3.9 kohms,1/6W	R258	VRS-TV2AB472J	J AA	4.7 kohms,1/10W
R133,134	VRS-TV2AB392J	J AA	3.9 kohms,1/10W	R259	VRS-TV2AB332J	J AA	3.3 kohms,1/10W
R135,136	VRS-TV2AB222J	J AA	2.2 kohms,1/10W	R260	VRS-TV2AB182J	J AA	1.8 kohms,1/10W
R137,138	VRS-TV2AB682J	J AA	6.8 kohms,1/10W	R261	VRD-ST2EE104J	J AA	100 kohm,1/4W
R139,140	VRS-TV2AB223J	J AA	22 kohms,1/10W	R262	VRS-TV2AB101J	J AA	100 ohm,1/10W
R141	VRS-TV2AB183J	J AA	18 kohms,1/10W	R263-267	VRS-TV2AB102J	J AA	1 kohm,1/10W
R143,144	VRD-ST2CD242J	J AA	2.4 kohms,1/6W	R268	VRD-ST2CD102J	J AA	1 kohm,1/6W
R145,146	VRS-TV2AB562J	J AA	5.6 kohms,1/10W	R270-272	VRS-TV2AB102J	J AA	1 kohm,1/10W
R149,150	VRS-TV2AB332J	J AA	3.3 kohms,1/10W	R273	VRD-ST2CD103J	J AA	10 kohm,1/6W
R151,152	VRS-TV2AB223J	J AA	22 kohms,1/10W	R274,275	VRS-TV2AB103J	J AA	10 kohm,1/10W
R153,154	VRS-TV2AB561J	J AA	560 ohms,1/10W	R276	VRS-TQ2BB103J	J AA	10 kohm,1/8W
R155,156	VRS-TV2AB104J	J AA	100 kohm,1/10W	R277-279	VRS-TV2AB103J	J AA	10 kohm,1/10W
R157,158	VRS-TV2AB223J	J AA	22 kohms,1/10W	R280	VRS-TV2AB102J	J AA	1 kohm,1/10W
R159,160	VRS-TV2AB562J	J AA	5.6 kohms,1/10W	R281	VRS-TV2AB123J	J AA	12 kohms,1/10W
R161	VRS-TV2AB334J	J AA	330 kohms,1/10W	R282	VRD-ST2EE682J	J AA	6.8 kohms,1/4W
R162	VRD-ST2CD473J	J AA	47 kohms,1/6W	R283	VRD-RT2HD821J	J AA	820 ohms,1/2W
R163,164	VRD-ST2EE153J	J AA	15 kohms,1/4W	R284	VRS-TV2AB103J	J AA	10 kohm,1/10W
R165,166	VRS-TV2AB100J	J AA	10 ohm,1/10W	R285	VRD-ST2EE101J	J AA	100 ohm,1/4W
R169,170	VRS-TV2AB123J	J AA	12 kohms,1/10W	R286	VRD-RT2HD151J	J AA	150 ohms,1/2W
R171,172	VRS-TV2AB103J	J AA	10 kohm,1/10W	R287	VRS-TV2AB332J	J AA	3.3 kohms,1/10W
R173,174	VRS-TV2AB104J	J AA	100 kohm,1/10W	R288	VRS-TV2AB123J	J AA	12 kohms,1/10W
R175,176	VRS-TV2AB473J	J AA	47 kohms,1/10W	R290	VRS-TV2AB333J	J AA	33 kohms,1/10W
R177,178	VRS-TV2AB222J	J AA	2.2 kohms,1/10W	R291	VRD-ST2EE821J	J AA	820 ohms,1/4W
R179,180	VRS-TV2AB103J	J AA	10 kohm,1/10W	R293,294	VRS-TV2AB223J	J AA	22 kohms,1/10W
R181,182	VRS-TV2AB473J	J AA	47 kohms,1/10W	R295,296	VRS-TV2AB103J	J AA	10 kohm,1/10W
R183,184	VRS-TV2AB101J	J AA	100 ohm,1/10W	R297	VRS-TV2AB472J	J AA	4.7 kohms,1/10W
R185,186	VRS-TV2AB221J	J AA	220 ohms,1/10W	R298	VRS-TV2AB103J	J AA	10 kohm,1/10W
R187,188	VRS-TV2AB223J	J AA	22 kohms,1/10W	R299	VRD-ST2EE271J	J AA	270 ohms,1/4W
R189	VRD-ST2EE333J	J AA	33 kohms,1/4W	△ RP101	RH-QX0004AWZZ	J AF	Posistor,2.2 ohms
R190	VRS-TQ2BB333J	J AA	33 kohms,1/8W	OTHER CIRCUITRY PARTS			
R191,192	VRS-TV2AB103J	J AA	10 kohm,1/10W	BI103/CNS103	QCWNW0786AWZZ	J AG	Connector Ass'y,11-11Pin
R193,194	VRS-TV2AB822J	J AA	8.2 kohms,1/10W	CNP101	92LCONE7P53014	J AC	Plug,7Pin
R195	VRS-TV2AB473J	J AA	47 kohms,1/10W	CNP102	92LCONPB2BPHK	J AB	Plug,2Pin
R196-198	VRS-TV2AB103J	J AA	10 kohm,1/10W	CNP103	92LCONEBP53254	J AD	Plug,11Pin
R199	VRS-TV2AB153J	J AA	15 kohms,1/10W	CNS101	QCWNW0788AWZZ	J AL	Connector Ass'y,7Pin
R200,201	VRD-ST2EE4R7J	J AA	4.7 ohms,1/4W	CNS102	QCWNW0787AWZZ	J AD	Connector Ass'y,2Pin
R202,203	VRS-TV2AB273J	J AA	27 kohms,1/10W	CNS104	92LCONE5P52147	J AD	Socket,5Pin
R205	VRS-TV2AB222J	J AA	2.2 kohms,1/10W	CNS105	92LCONE6P52147	J AD	Socket,6Pin
R206	VRS-TV2AB105J	J AA	1 Mohm,1/10W	CNS106	92LCONE7P52147	J AC	Socket,7Pin
R207	VRS-TV2AB103J	J AA	10 kohm,1/10W	CNS107	92LCONE4P52147	J AC	Socket,4Pin
R208	VRS-TQ2BB822J	J AA	8.2 kohms,1/8W	△ F101	92LFUSET801E	J AC	Fuse,T800mA L 250V
R209	VRD-ST2CD271J	J AA	270 ohms,1/6W	FW104	QCWNW0782AWZZ	J AD	Flat Wire,5Pin
R210	VRS-TV2AB153J	J AA	15 kohms,1/10W	FW105	QCWNW0783AWZZ	J AC	Flat Wire,6Pin
R211	VRS-TV2AB563J	J AA	56 kohms,1/10W	FW106	QCWNW0784AWZZ	J AD	Flat Wire,7Pin
R212	VRD-RT2HD181J	J AA	180 ohms,1/2W	FW107	QCWNW0785AWZZ	J AC	Flat Wire,4Pin
R213	VRD-RT2HD221J	J AA	220 ohms,1/2W	M251	RMOTV0010AWM1	J AN	Motor with Pulley [Tape]
R214,215	VRD-ST2CD561J	J AA	560 ohms,1/6W	PH401	VHPI31535CD-1	J AG	Photo Interrupter,I3153CD
R216	VRD-ST2CD223J	J AA	22 kohms,1/6W	SOC101	QCNCMZ015AWZZ	J	Socket,15Pin
R217	VRS-TV2AB563J	J AA	56 kohms,1/10W	SOL401	RPLU-0250AFZZ	J AG	Solenoid
R218	VRS-TV2AB222J	J AA	2.2 kohms,1/10W	SW101	QSW-K0003AWZZ	J AD	Switch,Key Type [Dolby NR]
R219	VRD-ST2CD332J	J AA	3.3 kohms,1/6W	SW102	QSW-K0003AWZZ	J AD	Switch,Key Type [Record/Pause]
R220	VRS-TV2AB104J	J AA	100 kohm,1/10W	SW103	QSW-K0003AWZZ	J AD	Switch,Key Type [Rewind]
R221	VRS-TV2AB563J	J AA	56 kohms,1/10W	SW104	QSW-K0003AWZZ	J AD	Switch,Key Type [Fast Forward]
R222	VRS-TV2AB561J	J AA	560 ohms,1/10W	SW105	QSW-K0003AWZZ	J AD	Switch,Key Type [Stop]
R223	VRD-ST2EE103J	J AA	10 kohm,1/4W	SW106	QSW-K0003AWZZ	J AD	Switch,Key Type [Side A Play]
R228	VRS-TV2AB104J	J AA	100 kohm,1/10W	SW107	QSW-K0003AWZZ	J AD	Switch,Key Type [Side B Play]
R229	VRS-TV2AB103J	J AA	10 kohm,1/10W	SW108	QSW-K0003AWZZ	J AD	Switch,Key Type [Reverse/Mode]
R230	VRS-TV2AB102J	J AA	1 kohm,1/10W	SW401	QSW-F9064AFZZ	J AC	Switch,Leaf Type [Tape Cassette Detection]
R231	VRS-TV2AB122J	J AA	1.2 kohms,1/10W	SW402	QSW-F9064AFZZ	J AC	Switch,Leaf Type [Tape Side B Erase Prevention]
R232	VRS-TV2AB681J	J AA	680 ohms,1/10W	SW403	QSW-F9065AFZZ	J AC	Switch,Leaf Type [Tape Main]
R233	VRS-TV2AB122J	J AA	1.2 kohms,1/10W	SW404	QSW-F9064AFZZ	J AC	Switch,Leaf Type [Tape Side A Erase Prevention]
R234	VRS-TV2AB681J	J AA	680 ohms,1/10W				
R235	VRS-TV2AB104J	J AA	100 kohm,1/10W				
R236	VRD-ST2EE102J	J AA	1 kohm,1/4W				
R237	VRS-TV2AB122J	J AA	1.2 kohms,1/10W				
R238	VRS-TV2AB272J	J AA	2.7 kohms,1/10W				
R239	VRS-TV2AB473J	J AA	47 kohms,1/10W				
R240	VRS-TV2AB122J	J AA	1.2 kohms,1/10W				

RT-XV300H

NO.	PART CODE	★	PRICE RANK	DESCRIPTION
SW405	QSW-F9064AFZZ	J	AC	Switch,Leaf Type [Tape CrO ₂ Detection]
SW406	QSW-F9064AFZZ	J	AC	Switch,Leaf Type [Tape Metal Detection]
TP101	92LCONE3P53253	J	AB	Plug,3Pin [Test Point]
TP102	QCNCM705DAFZZ	J	AB	Plug,4Pin [Test Point]

DECK MECHANISM PARTS

1	LANGF0022AWFW	J	AC	Bracket, Motor
2	92LM-ANG1756A	J	AD	Bracket, Lock Lever
3	92LM-CUSN1676A	J	AB	Cushion, Head
4	92LM-CASY1756A	J	AH	Main Chassis Ass'y
5	LBSHZ0086AFZZ	J	AA	Cushion, Motor
6	92LMSCASY1676B	J	AF	Reel Base Ass'y
7	LDAIH0112AFZZ	J	AD	Head Base Ass'y
8	LHLDS1077AFZZ	J	AD	Metal Holder Ass'y, Forward
9	LHLDS1078AFZZ	J	AC	Metal Holder Ass'y, Reverse
10	LHLDW1075AFZZ	J	AA	Nylon Band, 60mm
11	LPLTM0004AWZZ	J	AD	Plate, Head
12	92LM-HFPA1676A	J	AK	Head Mounting Plate Ass'y
15	92LM-CAM1676A	J	AC	Cam, Drive
16	92LM-OSLA1676A	J	AD	Overstroke Lever Ass'y
17	92LM-PRLA1676A	J	AD	Pinch Roller Drive Lever Ass'y
18	92LM-LEV1756B	J	AC	Lever, Lock Stopper
19	92LM-LEV1676A	J	AC	Lever, Brake
20	92LM-LEV1676B	J	AC	Lever, Cam Trigger
21	92LM-LEV1676C	J	AB	Lever, Eject Stopper
22	MLEVP0042AWZZ	J	AB	Lever, Lock
23	92LM-PLA1676A	J	AE	Play Gear Lever Ass'y
24	MLEVP0039AWM1	J	AG	FF/REW Gear Lever Ass'y
25	92LM-CSPR1676C	J	AA	Spring, Solenoid
26	MSPRC0916AFFJ	J	AA	Spring, Back Tension
27	MSPRD1217AFFJ	J	AA	Spring, Overstroke
28	MSPRD1218AFFJ	J	AA	Spring, Brake
29	MSPRD1219AFFJ	J	AA	Spring, Cam Trigger
30	MSPRD1220AFFJ	J	AA	Spring, Head Reverse
31	92LM-TSPR1676E	J	AA	Spring, Pinch Roller, Forward
32	92LM-TSPR1676F	J	AA	Spring, Pinch Roller, Reverse
33	MSPRD1223AFFJ	J	AA	Spring, Pinch Roller, Forward, Small
34	MSPRD1224AFFJ	J	AA	Spring, Pinch Roller, Reverse, Small
35	MSPRD1225AFFJ	J	AA	Spring, Pinch Roller Drive Lever
36	MSPRD1226AFFJ	J	AA	Spring, Play Gear Lever
37	MSPRD1227AFFJ	J	AA	Spring, FF/REW Gear Lever
38	MSPRD1290AFFJ	J	AA	Spring, Lock Lever
39	92LMCPFSR19A	J	AB	Spring, Cassette Press
41	MSPRT1520AFFJ	J	AA	Spring, Ground
42	NBLTH0001AWZZ	J	AC	Belt, Flywheel
44	NBLTK0514AFZZ	J	AA	Belt, FF/REW
45	92LM-REL1676A	J	AC	Reel
46	92LM-REL1676B	J	AB	Cap, Reel
47	NFLYC0010AWM1	J	AK	Flywheel Ass'y, Forward
48	NGERH0482AFZZ	J	AF	Limit Gear Ass'y
49	92LM-GEAR1676A	J	AB	Gear, Head
50	92LM-GEAR1676B	J	AB	Gear, Head Reverse
51	92LM-GEAR1676C	J	AC	Gear, Play
52	92LM-GEAR1676D	J	AC	Gear, FF/REW
53	92LM-GERA1676B	J	AB	Reel Sensor Gear Ass'y
55	MLEVP0040AWM1	J	AH	Pinch Roller Ass'y, Forward
56	MLEVP0041AWM1	J	AH	Pinch Roller Ass'y, Reverse
58	RHEDK0084AFZZ	J	AQ	Head, Playback/ Record/Erase
59	NFLYC0011AWM1	J	AK	Flywheel Ass'y, Reverse
60	MSPRD1282AFFJ	J	AB	Spring, FF/REW Gear
61	MSPRD1283AFFJ	J	AA	Spring, Sensor Gear
501	LX-BZ0004AWFD	J	AC	Screw, Lock Lever
502	92LS2S1676A	J	AA	Screw, $\phi 2 \times 6$ mm
503	LX-WZ9064AFZZ	J	AA	Washer, $\phi 1.5 \times \phi 3.8 \times 0.5$ mm
504	LX-WZ9069AFZZ	J	AA	Washer, $\phi 1.2 \times \phi 4 \times 0.25$ mm
506	LX-WZ9230AFZZ	J	AA	Washer, $\phi 1.8 \times \phi 4 \times 0.5$ mm
507	XBPSD14P05500	J	AA	Screw, $\phi 1.4 \times 5.5$ mm
509	XHBSD20P04000	J	AA	Screw, $\phi 2 \times 4$ mm
510	XHBSD20P05000	J	AA	Screw, $\phi 2 \times 5$ mm
511	XHBSD20P16000	J	AA	Screw, $\phi 2 \times 16$ mm
513	92L2R3W4R4R25P	J	AA	Washer, $\phi 2.3 \times \phi 4.4 \times 0.25$ mm
514	XWSSD20-06000	J	AA	Washer, $\phi 2 \times 0.6$ mm
515	92LS2R6S262B	J	AA	Special Screw, Motor
516	XWVSD22-03000	J	AA	Washer, $\phi 2.2 \times 0.3$ mm
519	LX-WZ9191AFZZ	J	AA	Washer, $\phi 1.6 \times \phi 3.4 \times 0.5$ mm
M251	RMOTV0010AWM1	J	AN	Motor with Pulley [Tape]
SOL401	RPLU-0250AFZZ	J	AG	Solenoid

NO.	PARTS CODE	★	PRICE RANK	DESCRIPTION
SW401	QSW-F9064AFZZ	J	AC	Switch, Leaf Type [Tape Cassette Detection]
SW402	QSW-F9064AFZZ	J	AC	Switch, Leaf Type [Tape Side B Erase Prevention]
SW403	QSW-F9065AFZZ	J	AC	Switch, Leaf Type [Tape Main]
SW404	QSW-F9064AFZZ	J	AC	Switch, Leaf Type [Tape Side A Erase Prevention]
SW405	QSW-F9064AFZZ	J	AC	Switch, Leaf Type [Tape CrO ₂ Detection]
SW406	QSW-F9064AFZZ	J	AC	Switch, Leaf Type [Tape Metal Detection]

CABINET PARTS

201	92LCAB2392AS1	J	AS	Front Panel Unit Ass'y
201-1	92LCUSN1585A	J	AA	Cushion, Leg
202	92LCAB2461AS1	J	BF	Front Panel Ass'y (Aluminum)
202-1	HDECQ0210AWSA	J	AG	Panel, LED
202-2	HPNLC3696AFSA	J	AX	Front Panel
204	LHLDX1006AWSA	J	AG	Holder, Cassette
205	MLIFP0003AWZZ	J	AE	Damper, Cassette Holder
206	MSPRD0094AWZZ	J	AB	Spring, Cassette Holder Up
207	JKNBZ0338AWSA	J	AE	Button, Record
208	JKNBZ0339AWSA	J	AE	Button, Cassette
209	HDECQ0178AWSA	J	AD	Cover, LED
211	LCHSM0047AWFW	J	AM	Main Chassis
△212	LBSHC0002AWZZ	J	AD	Bushing, AC Power Supply Cord
△213	QACCB0003AW00	J	BA	AC Power Supply Cord [For UK]
△213	QACCE0008AW00	J	AG	AC Power Supply Cord [For Europe]
214	GLEBP0005AWSA	J		Cushion
215	PRDAR0041AWFW	J	AG	Heat Sink
216	PSPA0018AWSA	J	AB	Spacer, Cushion
217	PGUMS0013AW00	J	AC	Cushion
218	92LN-BAND1318A	J	AA	Nylon Band, 80mm
219	LANGK0087AWFW	J	AE	Bracket
220	LANGF0029AWFW	J	AB	Bracket, Power Transformer
221	92LCAB2390CS1	J	AT	Top Cabinet
222	GITAR0216AWSA	J	AQ	Panel, Rear
223	92LCCOV2392AS1	J	AZ	Cassette Holder Cover Ass'y
223-1	GCOVA1136AWSA	J	AF	Cover, Cassette Holder
223-2	HDECQ0177AWSA	J	AF	Panel, Cassette Holder
225	GCOVA3113AFSA	J	AR	Cover, Front Panel
△226	92LFSHOLD1652T	J	AB	Holder, Fuse
△227	92LLUG1746A	J	AA	Lug, Terminal
228	PSHEZ0031AWZZ	J	AG	Shield Plate
229	TLABS0119AWZZ	J	AC	Label, Caution [UK Only]
230	92LCORE1777A	J	AE	Core
231	QCWNW1019AWZZ	J	AB	Lead Wire with Lug
601	XEBSD30P10000	J	AA	Screw, $\phi 3 \times 10$ mm
602	XHBSD30P08000	J	AA	Screw, $\phi 3 \times 8$ mm
603	LX-JZ0033AFFF	J	AA	Screw, $\phi 3 \times 8$ mm
604	XHSSD30P08000	J	AA	Screw, $\phi 3 \times 8$ mm
605	XESSD30P10000	J	AA	Screw, $\phi 3 \times 10$ mm
606	XJBSD30P08000	J	AA	Screw, $\phi 3 \times 8$ mm
607	LX-HZ0082AFZZ	J	AA	Screw, $\phi 4 \times 8$ mm
608	XEBSD26P10000	J	AA	Screw, $\phi 2.6 \times 10$ mm
609	XJBSF30P08000	J	AA	Screw, $\phi 3 \times 8$ mm
610	XJBSN30P08000	J	AA	Screw, $\phi 3 \times 8$ mm

ACCESSORIES/PACKING PARTS

1	SSAKH0019AWZZ	J	AD	Polyethylene Bag, Unit
2	SPAKA0125AWZZ	J	AG	Packing Add., Left/Right
3	TINSZ0215AWZZ	J	AM	Operation Manual
4	SSAKA0004AWZZ	J	AB	Polyethylene Bag, Accessories
5	QCNWG0019AWZZ	J	AQ	Extension Cable
6	92LBAG1728B	J	AA	Polyethylene Bag, Extension Cable
7	SPAKC0513AWZZ	J	AH	Packing Case
8	SPAKX0029AWZZ	J	AD	Pad, Protection
9	92LCARD1751A	J	AB	Registration Card [UK Only]
10	TLABE0165AWZZ	J	AB	Label, Bar Code

P.W.B. ASSEMBLY (Not Replacement Item)

△PWB-A1~5	92LPWB2463DECS	J	—	Main/Switch A,B,C/Power (Combined Ass'y) [UK Only]
PWB-B	QPWBF0190AWZZ	J	—	Tape Mechanism (PWB Only) [UK Only]

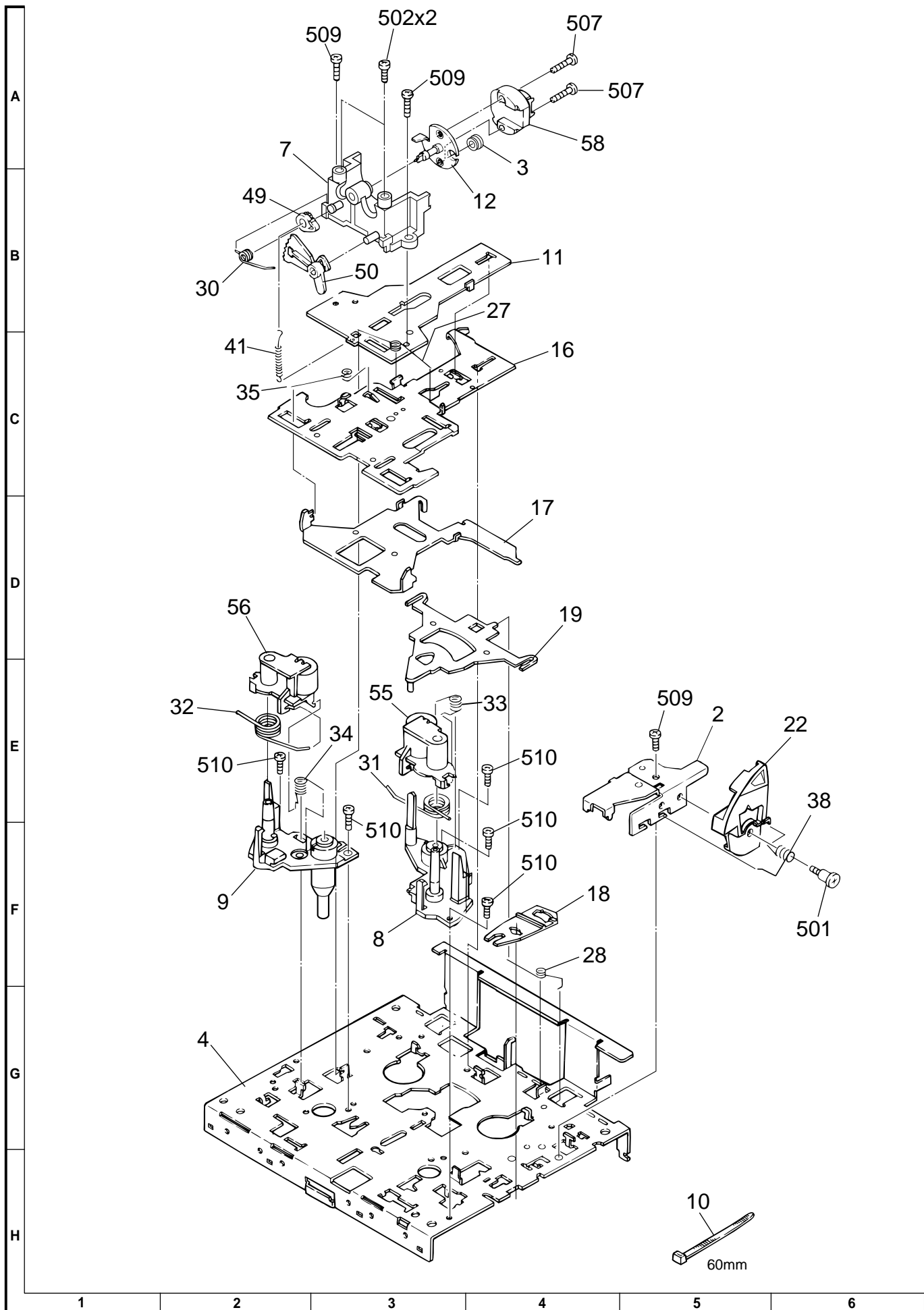

Figure 4 MECHANISM EXPLODE VIEW (1/2)

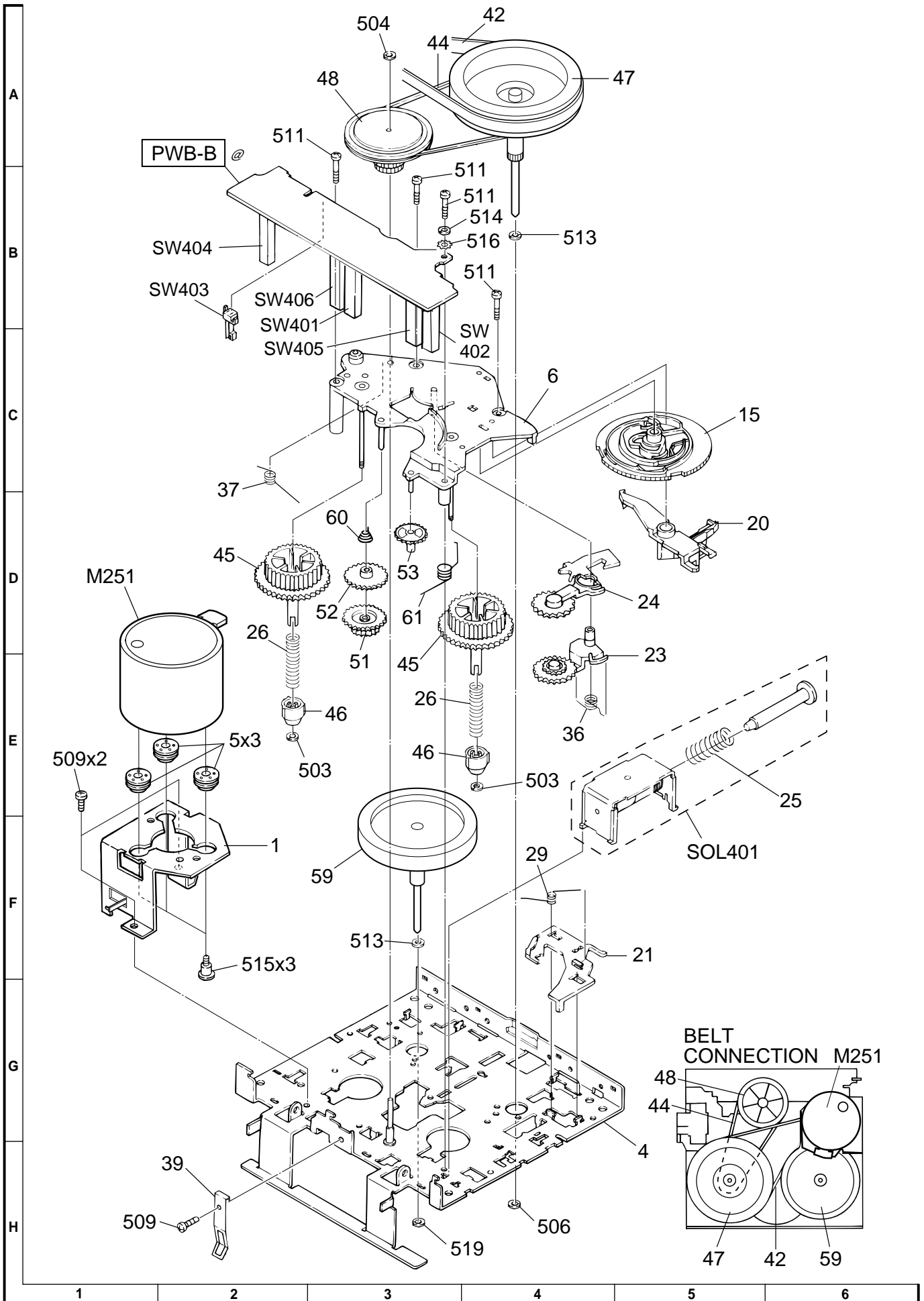

Figure 5 MECHANISM EXPLODE VIEW (2/2)

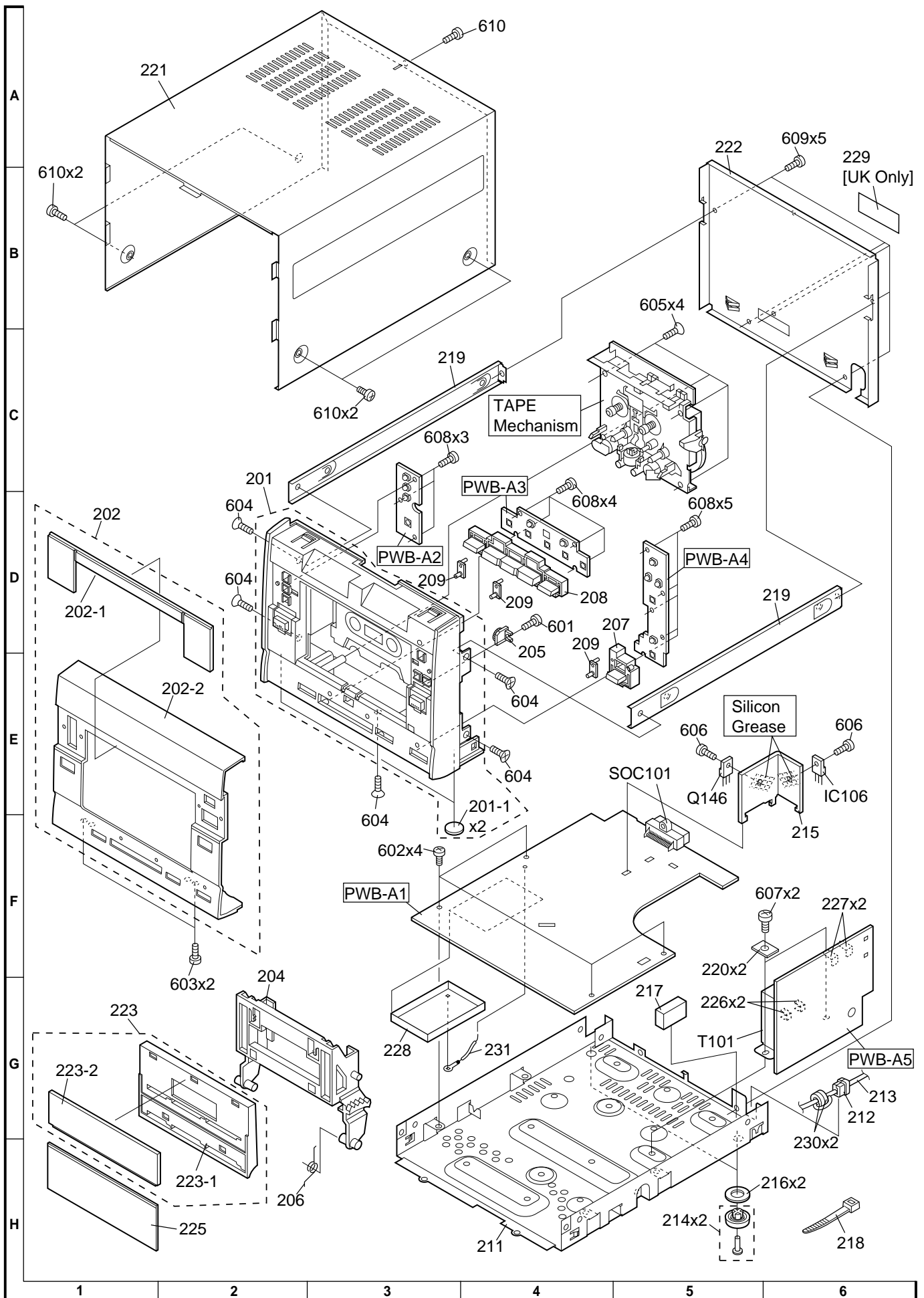

Figure 6 CABINET EXPLODED VIEW